



Hollybush Lane

Harpenden, AL5 4AL

A spacious two bedroom chalet bungalow of circa 1,000 sq ft with planning permission granted (ref 5/2020/1962), to convert the garage to living space and create an additional bedroom on the upper floor. Private garden and a fantastic central location, ideally placed for schooling. *CHAIN FREE*.

Guide price £725,000

Hollybush Lane

Harpenden, AL5 4AL



- Well proportioned
- Planning permission granted ref 5/2020/1962
- Ideally placed for schooling
- Circa 1,000 sq ft
- Private Garden
- Chain Free
- Two Double Bedrooms
- Central location

Entrance Hall

Living Room

16'6" x 12'1" (5.05 x 3.70)

Kitchen / Dining Room

11'9" x 11'8" (3.60 x 3.56)

Bedroom Two

12'7" x 11'9" (3.86 x 3.60)

Bathroom

Bedroom One

12'9" x 12'6" (3.91 x 3.82)

En-suite WC

Integral Garage

17'1" x 7'3" (5.23 x 2.23)

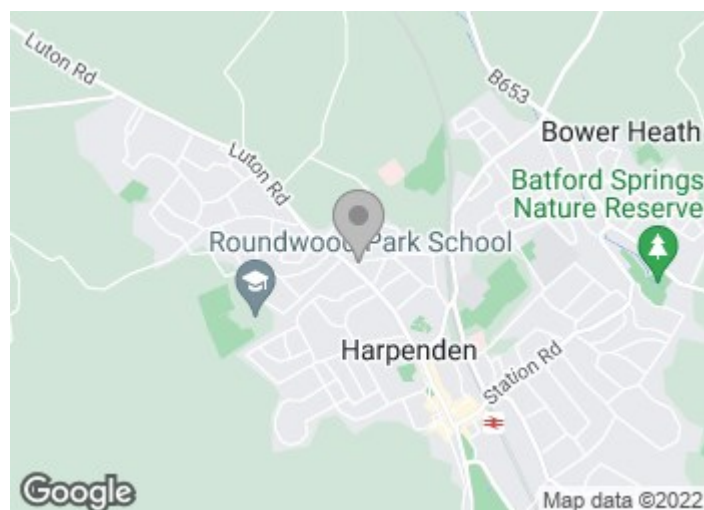



Floor Plan

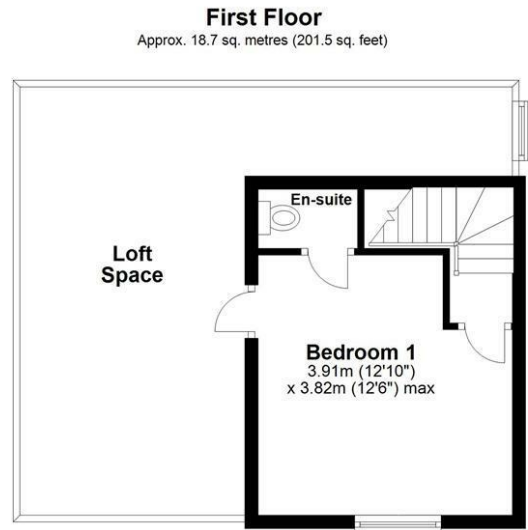

Total area: approx. 94.6 sq. metres (1018.7 sq. feet)

Sketch layout only. Not to scale. Plan produced for Whittaker & Co.

Plan produced using PlanUp.

These particulars, whilst believed to be accurate are set out as a general outline only for guidance and do not constitute any part of an offer or contract. Intending purchasers should not rely on them as statements of representation of fact, but must satisfy themselves by inspection or otherwise as to their accuracy. No person in this firm's employment has the authority to make or give any representation or warranty in respect of the property.

